



# INSTALLATION INSTRUCTIONS

Accessory  
**ARMREST WITH STORAGE  
COMPARTMENT**  
P/N 08U89-SCV-100

Application  
**2003 ELEMENT**

Publications No.  
**All 24275**  
Issue Date  
**DEC 2002**

## PARTS LIST

Armrest box

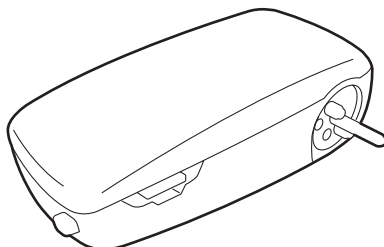

Base



2 Socket bolts



Owner's Manual

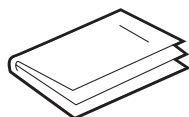

## TOOLS REQUIRED

Ratchet  
10 mm and 17 mm Sockets  
5 mm Hex wrench  
Torque wrench  
Utility knife  
Tape measure  
Felt-tip pen

## INSTALLATION

**NOTE:** Be careful not to damage the seat-back when installing the armrest console.

*If the vehicle is equipped with an armrest, continue with step 1, otherwise go to step 5.*

1. Zip open the armrest cover on the existing driver's seat, and turn over the cover as shown.

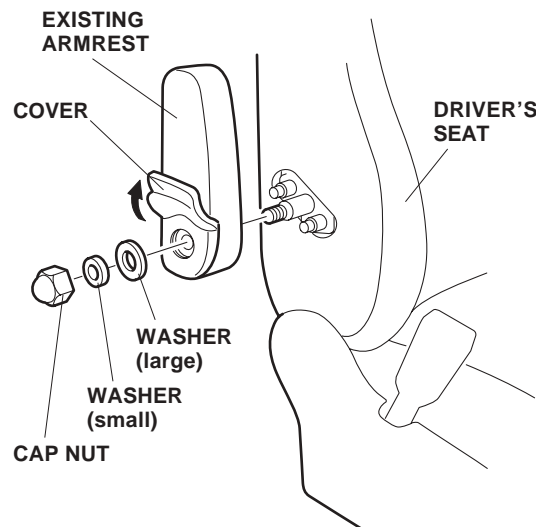

2. Remove the cap nut, small washer and large washer that secures the existing armrest, and remove the armrest.

3. Remove the base (two bolts). Set the armrest and the base with bolts aside; they will not be reused.

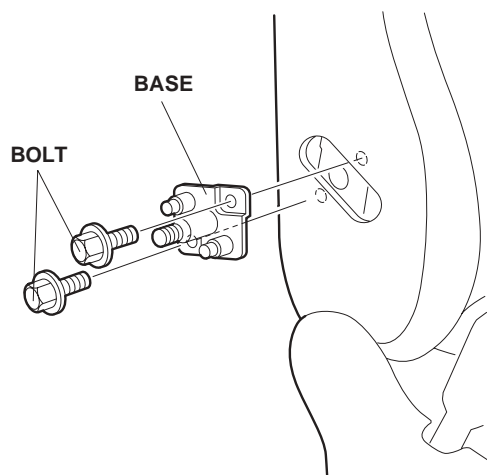

4. Using a tape measure and a felt-tip pen, measure and mark the seat-back cover in the area shown. Cut out the marked area from the seat-back cover with a utility knife, then go to step 7.

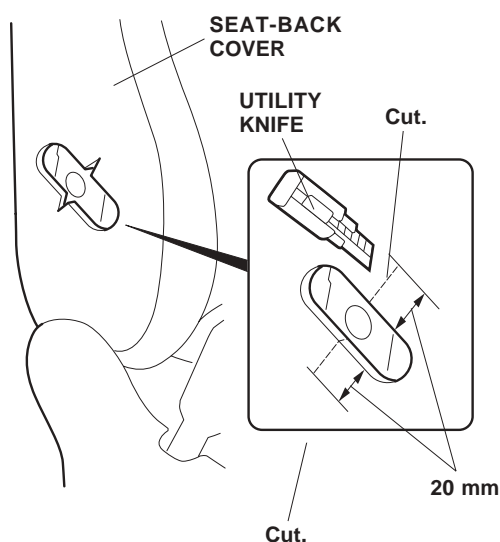

5. Using a felt-tip pen and tape measure, measure and mark the seat-back cover as shown. Push in on the mark, and confirm that the mark is centered over the hole in seat base.

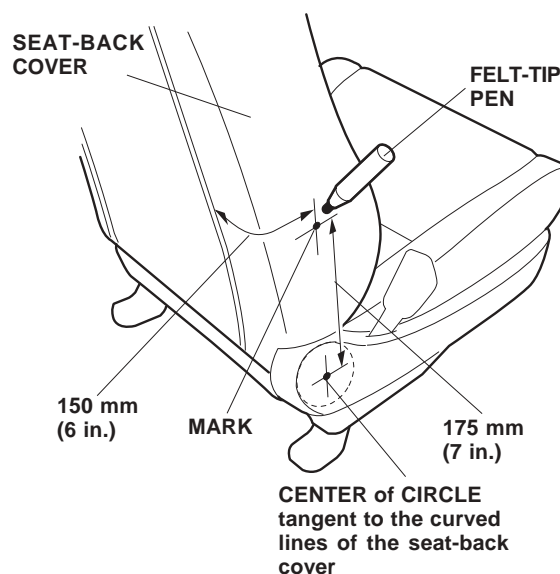

6. Using a utility knife, make two 70 mm (3 in.) cuts in the seat-back cover through the mark at right angle to each other as shown. Using these 70 mm (3 in.) cuts as a guide, cut out the marked area from the seat urethane to expose the seat base.

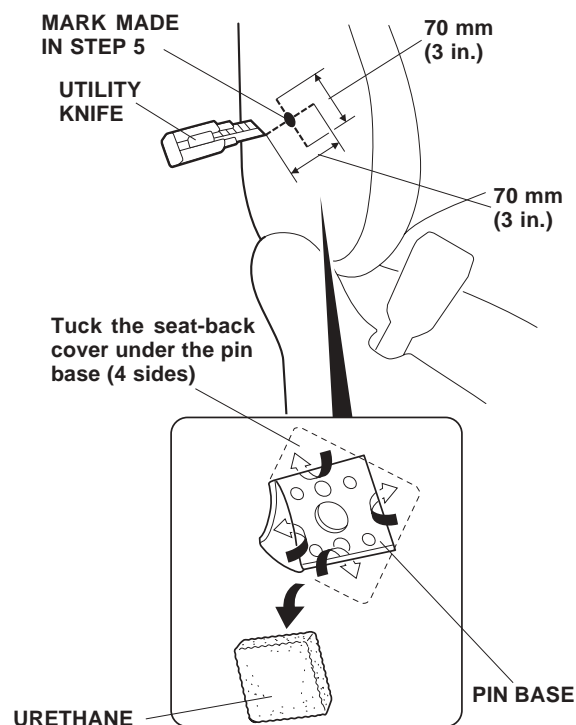

7. Get the new base from the kit, and position it on the pin base of the seat. Install the two socket bolts. Torque the socket bolts to 10-12 N·m (7-9 lbf·ft).

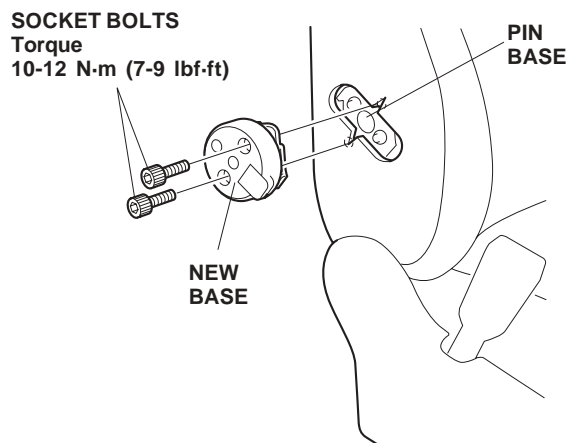

8. Insert the armrest into the holes in the base and push on it until it clicks into position. The white recessed portion of the push knob should be visible.

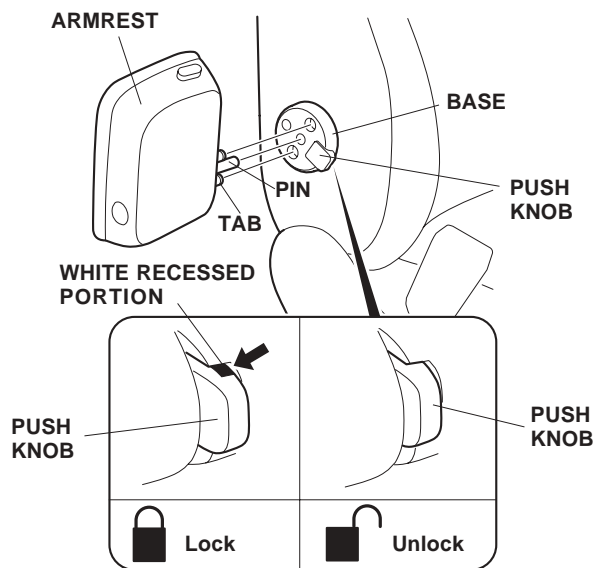

9. Check that the armrest operates properly by moving it up and down with your hand.
10. To release the armrest press on the push knob and pull out on the armrest.